

# PARTICIPATION PACKAGES 18 & 19 SEPTEMBER '24 TO NEW HEIGHTS.

## PARTICIPANT AS **EXHIBITOR**

As an **exhibitor**, in addition to the booth size, there are three participation options to choose from. The additional exposure allows you to customise the level of participation that suits your goals and preferences.

### PRIMARY CLASSIC PREMIUM

Entrance two person	●	●	●
Guest tickets	5	10	15
Display Innovation Forum	●	●	●
Exposure website	●	●	●
Contribution newsletter**		●	●
Social media attention		●	●
Business pitch*			●
Photography of booth***			●
Professional video****			●
	€ - <del>€500,-</del>	€ 500,- <del>€7.000,-</del>	€ 900,- <del>€1820,-</del>

### SIZE & PRICE

All prices are VAT excluded.

<b>Large</b> Price	<b>3 x 4 metres</b> € 4.575,-
<b>Medium</b> Price	<b>2 x 4 metres</b> € 3.090,-
<b>Small</b> Price	<b>2 x 3 metres</b> € 2.345,-
<b>Start-up</b> Price	<b>0.9 x 0,9 metres</b> € 500,-

\*Presentation on Expert stage

\*\* Maximum 500 words, with image

\*\*\* Five images: front, side & crew

\*\*\*\* 30-45 sec duration. Extra time possible at additional cost

### SMALL, MEDIUM, LARGE

## EXHIBITION INCLUDES

#### • Primary package

- Ready-made booth
  - Equipped with walls +/- 2.5 m high
  - Sign/logo at booth.
- Basic booth equipment:
  - Standing table with two chairs, light, an electricity point 220V with one outlet and WIFI.
- Professional marketing package:
  - Circular Textile Days' logo and banners for website, social media and e-mail.

- Logistic and building-up information.
- Recommendations for hotels, parking, access.
- Entree and lunch for 2 crew members.

**NOTE:** watertanks will be available at Congress Centre 1931 for you to tap fresh water all day long!

Would you like to expand your package to include additional lunch, tickets or other services, **please contact us.**



# START-UP PACKAGES

## 18 & 19 SEPTEMBER '24

### LET'S TALK CIRCULARITY



PARTICIPANT AS  
**START-UP**

As a **start-up** you'll be presented at a start-up square on the exhibition floor with a lounge facility closeby. You can choose from three participation options to boost your participation.

**Note:** Start-ups are companies less than 3 years old

	PRIMARY	CLASSIC	PREMIUM
Entrance for one	●	●	●
Guest tickets	5	10	15
Exposure website	●	●	●
Contribution newsletter**		●	●
Social media attention		●	●
Business pitch*			●
Photography of booth***			●
Professional video****			●
	€ - <del>€500,-</del>	€ 500,- <del>€7.000,-</del>	€ 900,- <del>€1820,-</del>

#### SIZE & PRICE

All prices are VAT excluded.

<b>Large</b> Price	3 x 4 metres € 4.575,-
<b>Medium</b> Price	2 x 4 metres € 3.090,-
<b>Small</b> Price	2 x 3 metres € 2.345,-
<b>Start-up</b> Price	0.9 x 0,9 metres € 500,-

\*Presentation on Expert stage

\*\* Maximum 500 words, with image

\*\*\* Five images: front, side & crew

\*\*\*\* 30-45 sec duration. Extra time possible at additional cost

#### THE SIZE & PRICE

### EXHIBITION INCLUDES

- **Primary** package
- 0.9 x 0.9 m2 Area
  - Sign/logo at booth.
  - Not provided with back walls.
- Basic booth equipment:
  - fixed table presentation 0.9 x 0.9 meter.
  - Free WIFI.
  - A shared electricity point 220V with one outlet can be **provided upon payment**.
- Professional marketing package:
  - Circular Textile Days' logo and banners for website, social media and e-mail.

- Logistic and building-up information.
- Recommendations for hotels, parking, access.
- Entree and lunch for 1 crew member.

**NOTE:** watertanks will be available at Congress Centre 1931 for you to tap fresh water all day long!

Would you like to expand your package to include additional lunch, tickets or other services, **please contact us**.



MEET POTENTIAL BUSINESS PARTNERS ON 18 & 19 SEPTEMBER 2024

Circular Textile Days | +31 (0)13 571 7947 | Info@circulartextiledays.com

About 1931

## LOCATION INSIGHT

1931 is an authentic congress centre. Centrally located in The Netherlands, with multifunctional facilities and a representative dark grey carpet on the booth floor.

**Feel free** to provide the booth with a different floor covering.

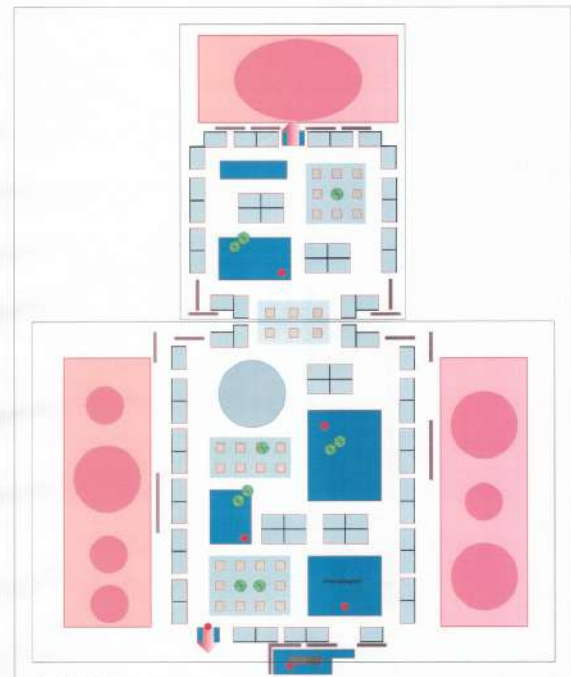
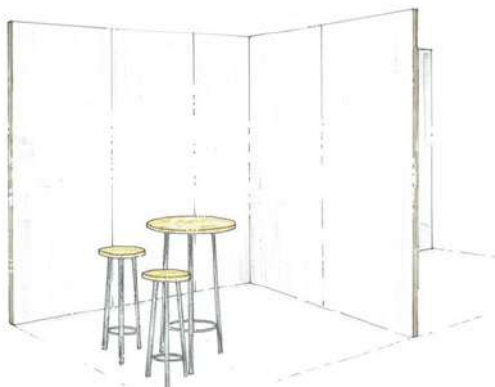
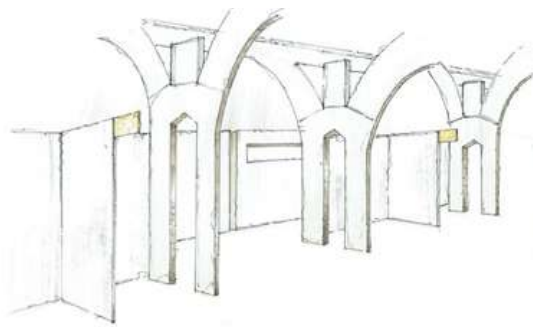

**SIGN UP VIA THE FOLLOWING LINK: BECOME AN EXHIBITOR**  
Circular Textile Days | +31 (0)13 571 7947 | [Info@circulartextiledays.com](mailto:Info@circulartextiledays.com)