

PARTICIPATION PACKAGES

18 & 19 SEPTEMBER '24

TO NEW HEIGHTS.

PARTICIPANT AS EXHIBITOR

As an **exhibitor**, in addition to the booth size, there are three participation options to choose from. The additional exposure allows you to customise the level of participation that suits your goals and preferences.

PRIMARY CLASSIC PREMIUM

Entrance for two	●	●	●
Guest tickets	5	10	15
Display Innovation Forum	●	●	●
Exposure website	●	●	●
Contribution newsletter**		●	●
Social media attention		●	●
Business pitch*			●
Photography of booth***			●
Professional video****			●
	€ - €500,-	€ 500,- €7.000,-	€ 900,- €1820,-

SIZE & PRICE

All prices are VAT excluded.

Large Price	3 x 4 metres € 4.575,-
Medium Price	2 x 4 metres € 3.090,-
Small Price	2 x 3 metres € 2.345,-
Start-up Price	1,2 x 0,8 metres € 500,-

*Presentation on Expert stage

** Maximum 500 words, with image

*** Five images: front, side & crew

**** 30-45 sec duration. Extra time possible at additional cost

SMALL, MEDIUM, LARGE

EXHIBITION INCLUDES

• Primary package

- Ready-made booth
 - Equipped with walls +/- 2.5 m high
 - Sign/logo at booth.
- Basic booth equipment:
 - Standing table with two chairs, light, an electricity point 220V with one outlet and WIFI.
- Professional marketing package:
 - Circular Textile Days' logo and banners for website, social media and e-mail.

- Logistic and building-up information.
- Recommendations for hotels, parking, access.
- Entree and lunch for 2 crew members.

NOTE: watertanks will be available at Congress Centre 1931 for you to tap fresh water all day long!

Would you like to expand your package to include additional lunch, tickets or other services, **please contact us.**

START-UP PACKAGES

18 & 19 SEPTEMBER '24

LET'S TALK CIRCULARITY



PARTICIPANT AS
START-UP

As a **start-up** you'll be presented at a start-up square on the exhibition floor with a lounge facility closeby. You can choose from three participation options to boost your participation.
Note: Start-ups are companies less than 3 years old

	PRIMARY	CLASSIC	PREMIUM
Entrance for one	●	●	●
Guest tickets	5	10	15
Exposure website	●	●	●
Contribution newsletter**		●	●
Social media attention		●	●
Business pitch*			●
Photography of booth***			●
Professional video****			●
	€ - €500,-	€ 500,- €7.000,-	€ 900,- €1820,-

SIZE & PRICE

All prices are VAT excluded.

Large Price	3 x 4 metres € 4.575,-
Medium Price	2 x 4 metres € 3.090,-
Small Price	2 x 3 metres € 2.345,-
Start-up Price	1,2 x 0,8 metres € 500,-

*Presentation on Expert stage

** Maximum 500 words, with image

*** Five images: front, side & crew

**** 30-45 sec duration. Extra time possible at additional cost

THE SIZE & PRICE

EXHIBITION INCLUDES

- **Primary** package
 - 1,2 x 0,8 m2 Area
 - Sign/logo at booth.
 - Not provided with back walls.
 - Basic booth equipment:
 - fixed table presentation 1,2 x 0,8 meter.
 - Free WIFI.
 - A shared electricity point 220V with one outlet can be **provided upon payment**.
 - Professional marketing package:
 - Circular Textile Days' logo and banners for website, social media and e-mail.

- Logistic and building-up information.
- Recommendations for hotels, parking, access.
- Entree and lunch for 1 crew member.

NOTE: watertanks will be available at Congress Centre 1931 for you to tap fresh water all day long!

Would you like to expand your package to include additional lunch, tickets or other services, **please contact us**.



MEET POTENTIAL BUSINESS PARTNERS ON 18 & 19 SEPTEMBER 2024

Circular Textile Days | +31 (0)13 571 7947 | Info@circulartextiledays.com

About 1931

LOCATION INSIGHT

1931 is an authentic congress centre. Centrally located in The Netherlands, with multifunctional facilities and a representative dark grey carpet on the booth floor.

Feel free to provide the booth with a different floor covering.

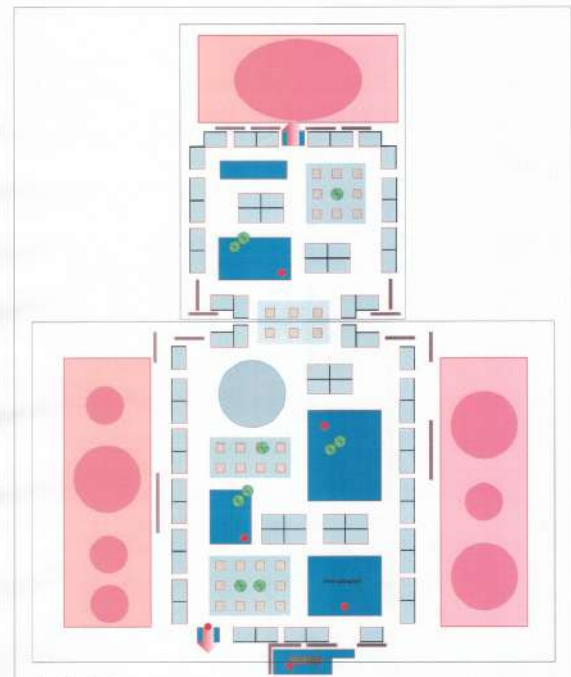
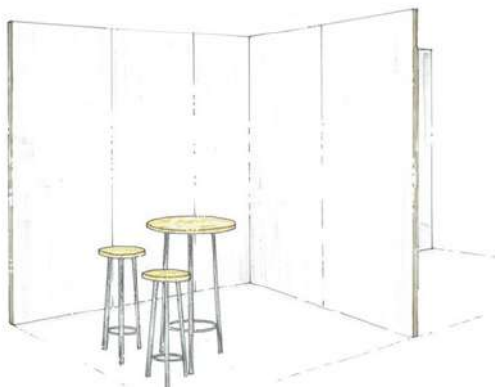
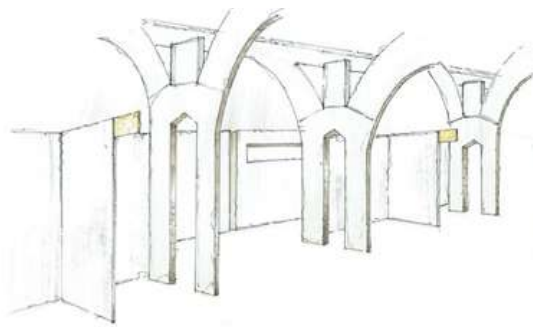

SIGN UP VIA THE FOLLOWING LINK: BECOME AN EXHIBITOR
Circular Textile Days | +31 (0)13 571 7947 | Info@circulartextiledays.com